

High Pressure Check Valves

C15, C15B Series, 15,000 psi (1034 bar)

C20, C20B Series, 20,000 psi (1379 bar)

C60, C60B Series, 60,000 psi (4137 bar)



1540 Clinton Square
Rochester
New York
USA 14604

Tel.: 1-855-693-4638
Fax: 1-877-297-4661
E-mail: info@finelok.com



www.finelok.com

Contents

C15 Series	
O-Ring Check Valves	1
Pipe O-Ring Check Valves	2
C15B Series	
Ball Check Valves	3
Pipe Ball Check Valves	4
C20 Series	
O-Ring Check Valves	5
C20B Series	
Ball Check Valves	6
C60 Series	
O-Ring Check Valves	7
C60B Series	
Ball Check Valves	8
Ordering Information	9

C15 Series

15,000 psi (1034 bar)

O-Ring Check Valves

Features

- ☆ Provides unidirectional flow and tight shut-off for liquids and gas with high reliability. When differential drops below cracking pressure, valves shuts off (Not for use as relief valve).
- ☆ Tubing sizes available for 1/4", 3/8", 1/2".
- ☆ Resilient O-ring seat design for noise-free closing leakage-free.
- ☆ Maximum working pressure: 15,000 psig (1034 bar).
- ☆ Working temperature: 0°F (-17.8°C) to 400°F (204°C).
- ☆ Cracking pressure: 14 psig ~ 26 psig (0.966 bar ~ 1.794 bar).

Standard Materials

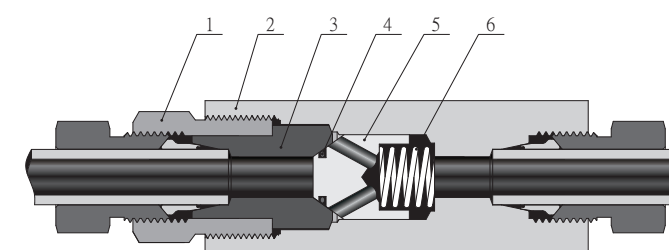

Item	Component	Valve Material
1	Cover Gland	316 SS/A479
2	Valve Body	316 SS/A479
3	Cover	316 SS/A479
4	O-Ring	Fluorocarbon FKM
5	Poppet	316 SS/A479
6	Spring	300 Series Stainless Steel
	Lubricant	Molybdenum disulfide

Technical Data and Dimensions

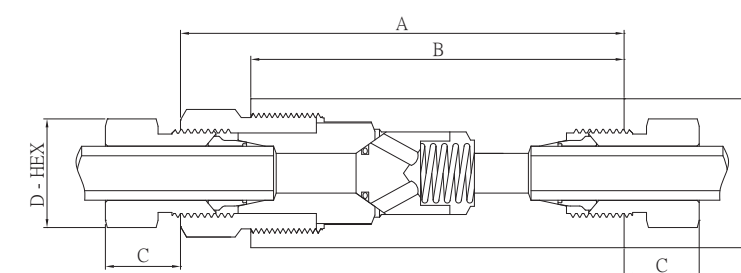

Ordering Number	Connection Type	Orifice in.(mm)	Rated Cv	A	B	C	D - HEX	HEX	Pressure/Temperature Rating psig (bar) @ Room Temperature
				in. (mm)					
SS-C15-S4	15S4	0.188 (4.78)	0.63	3.18 (80.77)	2.56 (65.02)	0.44 (11.18)	0.63 (16.00)	0.81 (20.57)	15,000 (1034)
SS-C15-S6	15S6	0.250 (6.35)	1.70	3.56 (90.42)	3.00 (76.20)	0.53 (13.46)	0.75 (19.05)	1.00 (25.40)	15,000 (1034)
SS-C15-S8	15S8	0.375 (9.53)	3.40	4.18 (106.17)	3.50 (88.90)	0.53 (13.46)	0.93 (23.62)	1.38 (35.05)	15,000 (1034)

Pipe O-Ring Check Valves

Features

- ☆ Provides unidirectional flow and tight shut-off for liquids and gas with high reliability. When differential drops below cracking pressure, valves shuts off (Not for use as relief valve).
- ☆ Resilient O-ring seat design for noise-free closing leakage-free.
- ☆ Maximum working pressure: 15,000 psig (1034 bar).
- ☆ Working temperature: 0°F (-17.8°C) to 400°F (204°C).
- ☆ Cracking pressure: 14 psig ~ 26 psig (0.966 bar~1.794 bar).

Standard Materials

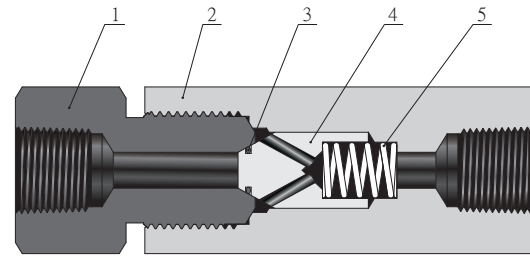

Item	Component	Valve Material
1	Cover Gland	316 SS/A479
2	Valve Body	316 SS/A479
3	O-Ring	Fluorocarbon FKM
4	Poppet	316 SS/A479
5	Spring	300 Series Stainless Steel
	Lubricant	Molybdenum disulfide

Technical Data and Dimensions

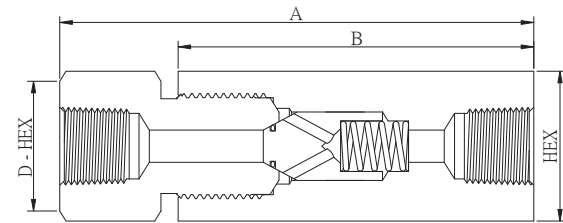

Ordering Number	Connection Type	Orifice in.(mm)	Rated Cv	A	B	D - HEX	HEX	Pressure/Temperature Rating psig (bar) @ Room Temperature
				in. (mm)				
SS-C15-FNT4	FNT4	0.12 (3.05)	0.28	3.37 (85.60)	2.38 (60.33)	0.94 (23.81)	0.94 (23.81)	15,000 (1034)
SS-C15-FNT6	FNT6	0.22 (5.59)	0.84	3.95 (100.33)	2.88 (73.15)	1.13 (28.58)	1.13 (28.58)	15,000 (1034)
SS-C15-FNT8	FNT8	0.34 (8.70)	2.30	4.63 (117.50)	3.5 (88.90)	1.38 (34.93)	1.38 (34.93)	15,000 (1034)

C15B Series

15,000 psi (1034 bar)

Ball Check Valves

Features

- ☆ Prevents reverse flow where leak-tight shut-off is not mandatory. When differential drops below cracking pressure, valves closes (Not for use as relief valve).
- ☆ Tubing sizes available for 1/4", 3/8", 1/2".
- ☆ Maximum working pressure:15,000 psig (1034 bar).
- ☆ Working temperature: -325°F (-198°C) to 800°F (427°C).
- ☆ Ball and poppet are an integral design to assure positive, in-line seating without "chatter". poppet is designed essentially for axial flow with minimum pressure drop.

Standard Materials

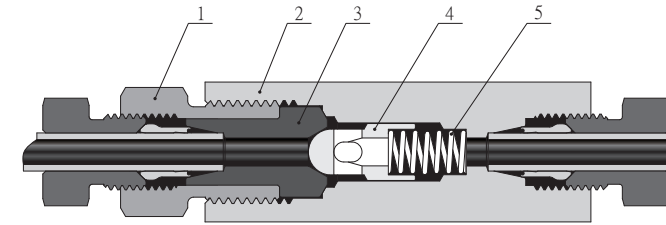

Item	Component	Valve Material
1	Cover Gland	316 SS/A479
2	Valve Body	316 SS/A479
3	Cover	316 SS/A479
4	Ball Poppet	316 SS/A479
5	Spring	300 Series Stainless Steel
	Lubricant	Molybdenum disulfide

Technical Data and Dimensions

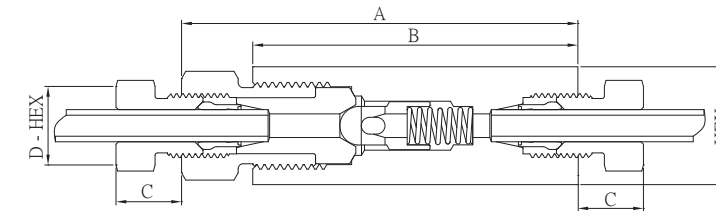

Ordering Number	Connection Type	Orifice in.(mm)	Rated Cv	A	B	C	D - HEX	HEX	Pressure/Temperature Rating psig (bar) @ Room Temperature
				in. (mm)					
SS-C15B-S4	15S4	0.188 (4.78)	0.63	3.18 (80.77)	2.56 (65.02)	0.44 (11.18)	0.63 (16.00)	0.81 (20.57)	15,000 (1034)
SS-C15B-S6	15S6	0.250 (6.35)	1.70	3.56 (90.42)	3.00 (76.20)	0.53 (13.46)	0.75 (19.05)	1.00 (25.40)	15,000 (1034)
SS-C15B-S8	15S8	0.375 (9.53)	3.40	4.18 (106.17)	3.50 (88.90)	0.53 (13.46)	0.93 (23.62)	1.38 (35.05)	15,000 (1034)

Pipe Ball Check Valves

Features

- ☆ Prevents reverse flow where leak-tight shut-off is not mandatory. When differential drops below cracking pressure, valves closes (Not for use as relief valve).
- ☆ Maximum working pressure: 15,000 psig (1034 bar).
- ☆ Working temperature: -325°F (-198°C) to 400°F (204°C).
- ☆ Ball and poppet are an integral design to assure positive, in-line seating without "chatter". poppet is designed essentially for axial flow with minimum pressure drop.

Standard Materials

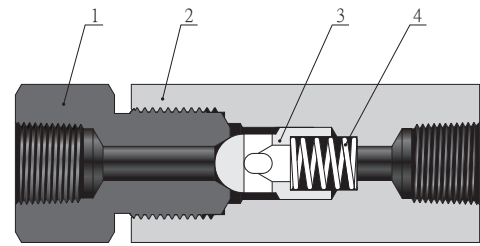

Item	Component	Valve Material
1	Cover Gland	316 SS/A479
2	Valve Body	316 SS/A479
3	Ball Poppet	316 SS/A479
4	Spring	300 Series Stainless Steel
	Lubricant	Molybdenum disulfide

Technical Data and Dimensions

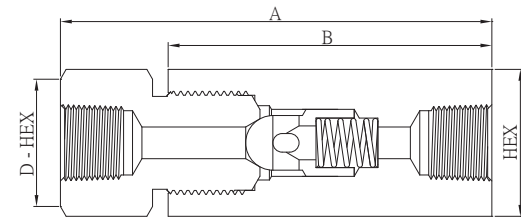

Ordering Number	Connection Type	Orifice in.(mm)	Rated Cv	A	B	D - HEX	HEX	Pressure/Temperature Rating psig (bar) @ Room Temperature
				in. (mm)				
SS-C15B-FNT4	FNT4	0.12 (3.05)	0.28	3.37 (85.60)	2.38 (60.33)	0.94 (23.81)	0.94 (23.81)	15,000 (1034)
SS-C15B-FNT6	FNT6	0.22 (5.59)	0.84	3.95 (100.33)	2.88 (73.15)	1.13 (28.58)	1.13 (28.58)	15,000 (1034)
SS-C15B-FNT8	FNT8	0.36 (9.12)	2.30	5.36 (136.14)	3.88 (98.55)	1.38 (34.93)	1.38 (34.93)	15,000 (1034)

C20 Series

20,000 psi (1379 bar)

O-Ring Check Valves

Features

- ☆ Provides unidirectional flow and tight shut-off for liquids and gas with high reliability. When differential drops below cracking pressure, valves shuts off (Not for use as relief valve).
- ☆ Tubing sizes available for 1/4" to 1".
- ☆ Resilient O-ring seat design for noise-free closing leakage-free.
- ☆ Maximum working pressure: 20,000 psig (1379 bar).
- ☆ Working temperature: 0°F (-17.8°C) to 400°F (204°C).
- ☆ Cracking pressure: 14 psig ~ 26 psig (0.966 bar~1.794 bar).

Standard Materials

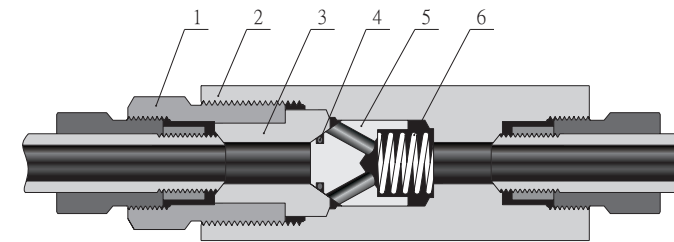

Item	Component	Valve Material
1	Cover Gland	316 SS/A479
2	Valve Body	316 SS/A479
3	Cover	316 SS/A479
4	O-Ring	Fluorocarbon FKM
5	Poppet	316 SS/A479
6	Spring	300 Series Stainless Steel
	Lubricant	Molybdenum disulfide

Technical Data and Dimensions

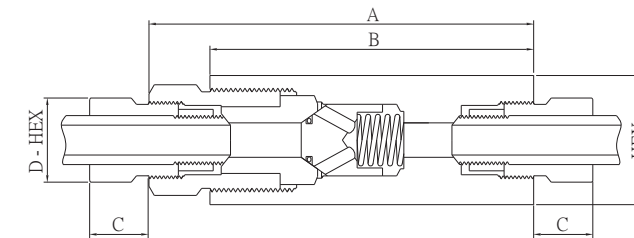

Ordering Number	Connection Type	Orifice in.(mm)	Rated Cv	A	B	C	D - HEX	HEX	Pressure/Temperature Rating psig (bar) @ Room Temperature
				in. (mm)					
SS-C20-S4	20S4	0.125 (3.18)	0.28	2.94 (74.68)	2.50 (63.50)	0.38 (9.65)	0.50 (12.70)	0.81 (20.57)	20,000 (1379)
SS-C20-S6	20S6	0.218 (5.54)	0.84	3.12 (79.25)	2.62 (66.55)	0.47 (11.94)	0.62 (15.75)	1.00 (25.40)	20,000 (1379)
SS-C20-S9	20S9	0.359 (9.12)	2.30	4.18 (106.17)	3.50 (88.90)	0.53 (13.46)	0.94 (23.88)	1.38 (35.05)	20,000 (1379)
SS-C20-S12	20S12	0.516(13.11)	4.70	5.50 (139.70)	4.75 (120.65)	0.62 (15.75)	1.19 (30.23)	1.75 (44.45)	20,000 (1379)
SS-C20-S16	20S16	0.688(17.48)	7.40	6.63 (168.40)	5.75 (146.05)	0.72 (18.29)	1.38 (35.05)	2.12 (53.85)	20,000 (1379)

C20B Series

20,000 psi (1379 bar)

Ball Check Valves

Features

- ☆ Prevents reverse flow where leak-tight shut-off is not mandatory. When differential drops below cracking pressure, valves closes. (Not for use as relief valve)
- ☆ Tubing sizes available for 1/4" to 1".
- ☆ Maximum working pressure: 20,000 psig (1379 bar).
- ☆ Working temperature: -423°F (-252°C) to 1200°F (649°C).
- ☆ Ball and poppet are an integral design to assure positive, in-line seating without "chatter". poppet is designed essentially for axial flow with minimum pressure drop.

Standard Materials

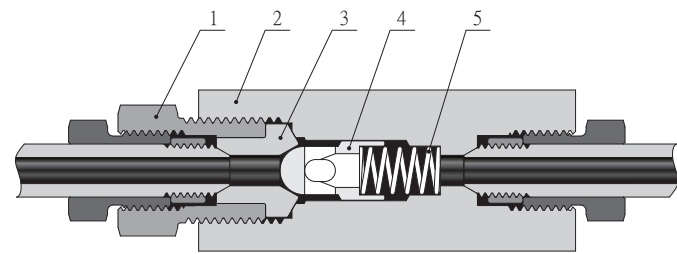

Item	Component	Valve Material
1	Cover Gland	316 SS/A479
2	Valve Body	316 SS/A479
3	Cover	316 SS/A479
4	Ball Poppet	316 SS/A479
5	Spring	300 Series Stainless Steel
	Lubricant	Molybdenum disulfide

Technical Data and Dimensions

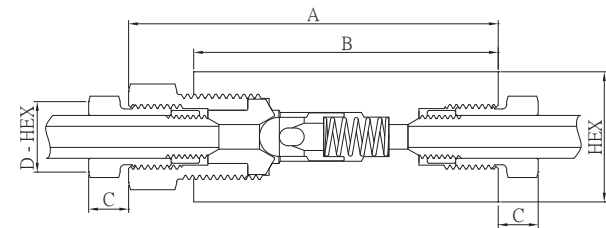

Ordering Number	Connection Type	Orifice in.(mm)	Rated Cv	in. (mm)					Pressure/Temperature Rating psig (bar) @ Room Temperature
				A	B	C	D - HEX	HEX	
SS-C20B-S4	20S4	0.125 (3.18)	0.28	2.94 (74.68)	2.50 (63.50)	0.38 (9.65)	0.50 (12.70)	0.81 (20.57)	20,000 (1379)
SS-C20B-S6	20S6	0.218 (5.54)	0.84	3.12 (79.25)	2.62 (66.55)	0.47 (11.94)	0.62 (15.75)	1.00 (25.40)	20,000 (1379)
SS-C20B-S9	20S9	0.359 (9.12)	2.30	4.18 (106.17)	3.50 (88.90)	0.53 (13.46)	0.94 (23.88)	1.38 (35.05)	20,000 (1379)
SS-C20B-S12	20S12	0.516(13.11)	4.70	5.50 (139.70)	4.75 (120.65)	0.62 (15.75)	1.19 (30.23)	1.75 (44.45)	20,000 (1379)
SS-C20B-S16	20S16	0.688(17.48)	7.40	6.63 (168.40)	5.75 (146.05)	0.72 (18.29)	1.38 (35.05)	2.12 (53.85)	20,000 (1379)

C60 Series

60,000 psi (4137 bar)

O-Ring Check Valves

Features

- ☆ Provides unidirectional flow and tight shut-off for liquids and gas with high reliability. When differential drops below cracking pressure, valves shuts off (Not for use as relief valve).
- ☆ Tubing sizes available for 1/4" to 9/16".
- ☆ Resilient O-ring seat design for noise-free closing leakage-free.
- ☆ Maximum working pressure: 60,000 psig (4137 bar).
- ☆ Working temperature: 0°F (-17.8°C) to 400°F (204°C).
- ☆ Cracking pressure: 14 psig ~ 26 psig (0.966 bar~1.794 bar).

Standard Materials

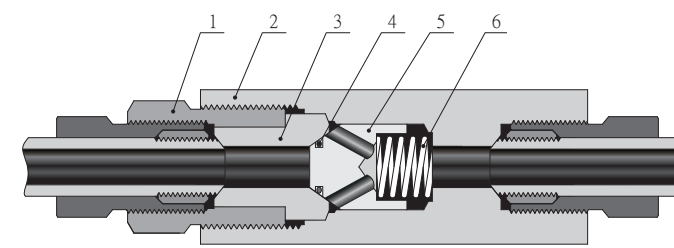

Item	Component	Valve Material
1	Cover Gland	316 SS/A479
2	Valve Body	316 SS/A479
3	Cover	316 SS/A479
4	O-Ring	Fluorocarbon FKM
5	Poppet	316 SS/A479
6	Spring	300 Series Stainless Steel
	Lubricant	Molybdenum disulfide

Technical Data and Dimensions

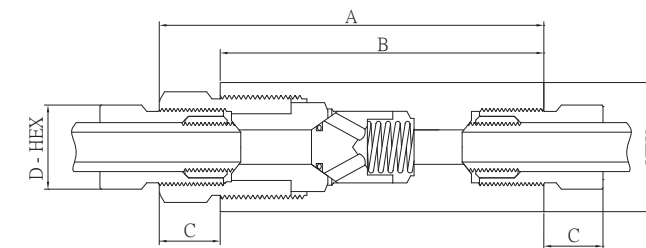

Ordering Number	Connection Type	Orifice in.(mm)	Rated Cv	in (mm)					Pressure/Temperature Rating psig (bar) @ Room Temperature
				A	B	C	D - HEX	HEX	
SS-C60-S4	60S4	0.094(2.39)	0.15	3.38 (85.85)	2.50 (63.50)	0.50 (12.70)	0.63 (16.00)	1.18 (29.97)	60,000 (4137)
SS-C60-S6	60S6	0.125(3.18)	0.28	3.75 (95.25)	2.62 (66.55)	0.53 (13.46)	0.75 (19.05)	1.18 (29.97)	60,000 (4137)
SS-C60-S9	60S9	0.187(4.75)	0.63	4.62 (117.35)	3.38 (85.85)	0.81 (20.57)	1.12 (28.45)	1.50 (38.10)	60,000 (4137)

C60B Series

60,000 psi (4137 bar)

Ball Check Valves

Features

- ☆ Prevents reverse flow where leak-tight shut-off is not mandatory. When differential drops below cracking pressure, valves closes. (Not for use as relief valve)
- ☆ Tubing sizes available for 1/4" to 9/16".
- ☆ Maximum working pressure: 60,000 psig (4137 bar).
- ☆ Working temperature: -423°F (-252°C) to 1200°F (649°C).
- ☆ Ball is cradled in floating poppet to assure positive, in-line seating without "chatter". poppet is designed essentially for axial flow with minimum pressure drop.

Standard Materials

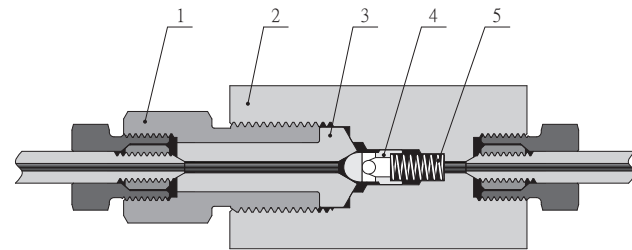

Item	Component	Valve Material
1	Cover Gland	316 SS/A479
2	Valve Body	316 SS/A479
3	Cover	316 SS/A479
4	Ball Poppet	316 SS/A479
5	Spring	300 Series Stainless Steel
	Lubricant	Molybdenum disulfide

Technical Data and Dimensions

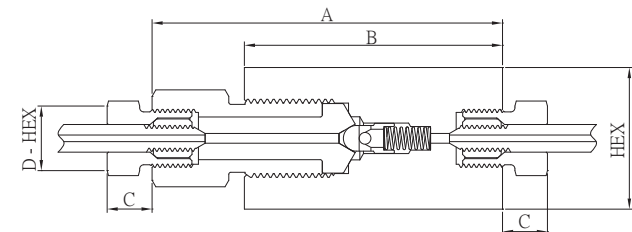

Ordering Number	Connection Type	Orifice in.(mm)	Rated Cv	A	B	C	D - HEX	HEX	Pressure/Temperature Rating psig (bar) @ Room Temperature
				in. (mm)					
SS-C60B-S4	60S4	0.094 (2.39)	0.15	3.38 (85.85)	2.50 (63.50)	0.50 (12.70)	0.63 (16.00)	1.18 (29.97)	60,000 (4137)
SS-C60B-S6	60S6	0.125 (3.18)	0.28	3.75 (95.25)	2.62 (66.55)	0.53 (13.46)	0.75 (19.05)	1.18 (29.97)	60,000 (4137)
SS-C60B-S9	60S9	0.187(4.75)	0.63	4.62 (117.35)	3.38 (85.85)	0.81 (20.57)	1.12 (28.45)	1.50 (38.10)	60,000 (4137)

NOTE:

All dimensions are for reference only and are subject to change. For dimensions not shown above, please contact the authorized representative or FINELOK.

Ordering Information

